

Kingsbridge in Bloom 2015



Royal
Horticultural
Society



Britain in Bloom **South West**



UK FINALIST
2015

"Kynsbygge" (King's Bridge) – its name deriving from a 10th century bridge linking two royal estates, gently nestling where it has for over 1000 years at the head of its eponymous estuary, enjoying the warmth of the Gulf Stream with none of the perils of the open sea, this historic market town embodies all the best principles of the Britain in Bloom movement.

A town of 6,000+ souls, rising to some 15,000 including its catchment of parishes who naturally look to Kingsbridge as their hub, many of whom share the Saltstone as a boundary marker. This table shaped rock situated in the upper reaches of what is more properly a ria, effectively sat outside the jurisdiction of any parish; was only accessible at particular states of the tide and due to its exposed location, could not readily be approached by the authorities; it became the 'safe' meeting place for many of the nonconformist believers granted haven in the town - safe until its surface disappeared with the incoming waves!

It is that free-thinking, welcoming inclusivity which has defined much of the town's history to the present day – an ethos fiercely upheld by the present community, a lively and harmonious mix of families whose own history is inseparable from the town and more recent additions keen to preserve that which attracted them here initially. An aim no better achieved than by Growing Pride in Our Town.

Now a combination of two ancient settlements:

Dodbrooke - the older and initially dominant with its own market from 1257 and a borough by 1319 clustered around the parish church dedicated to St Thomas a Becket (endowed as an act of penitence by one of those knights who murdered the saint after banishment to his nearby manor).

and

Kingsbridge - formerly a possession of the Abbots of Buckfastleigh, established as a borough by 1238 with a charter to hold its own market, the 550th anniversary of that grant celebrated throughout the town in 2011 by 4 days of Mediaeval markets, entertainment and merriment, the highlight of which a spectacular Flower Festival in their parish church of St Edmund, King & Martyr

Kingsbridge is very much a working town, an all-year-round town; lively and thriving, where its residents both permanent and seasonal can happily pursue a myriad of interests whilst enjoying a pace and quality of life sadly lost elsewhere.

But do not dismiss us as a gently dozing backwater - this is also a town of inventors and entrepreneurs; world leaders in industry; local businesses who have become national, even global, names; artists, artisans and authors; craftsmen - and horticulturalists!

From the banks of croci grown for saffron by the monks until Dissolution of the Monasteries (historical heritage recreated by the neighbourhood garden lovingly tended by residents of Saffron Park) to Queen Victoria despatching her gardener to understand the escalier method of growing oranges she so enjoyed from the neighbouring Coombe Royal estate - the art and craft of gardening has long been practised in these parts.

Entirely fitting therefore it is this common, inclusive, interest which unites so many sectors of our community in enjoyment and pleasure...

from Beavers to Brownies; local schoolchildren with outdoor classrooms and wildlife havens, growing plots and gardening clubs;

the elderly, less mobile; the vulnerable and lonely - with sensory areas, sunny spots to sit and share memories, planted areas requiring minimal physical effort less able-bodied can tend; projects centred around those with special needs which encourage their special gifts to us all;

older students fascinated by the science of horticulture; sustainability of plants and crops; climate adaptation and resistance - in practice, in their town;

a community garden for all to visit and embrace its tranquility and calm in our own way, our own time; to feel again the trickle of soil through fingers, harvest home-grown produce; savour the scent of fresh picked flowers and honey from the bees - reclaimed pleasures for the many whose properties offer no outside space;

forging links with members of other organisations, societies and groups to enhance their own activities – the quilters whose exquisite stitching record planting around the town; the ladies (and gentlemen) of the country market whose tasty treats take full advantage of produce from the community garden; the flower arrangers who delight in beautifying the local churches for flower festivals, Kingsbridge in Bloom events and celebrations; those whose anniversaries and centenaries have been the subject of themed beds – and the many non-green fingered in the community who avidly support the fund raising quizzes and caelidhs; the barn dances and BBQs, in grateful appreciation of the volunteers' hard work;

the heritage and history of the town preserved, recreated, remembered in secret corners, back ways and ancient paths, disused lime kilns and stone remnants of the long disused but oh-so-pretty Primrose Branch Line;

the list is endless – the work unceasing – the enthusiasm no less on a cold winter's day – and the results, a joy for all to behold.

This is our eighth year as an entrant in the Britain in Bloom South West competition and we are keen to maintain our high standard for our town.

We are particularly privileged this year to have been invited by the RHS to participate in the National Finals.

People in Kingsbridge recognise the contribution that Kingsbridge in Bloom has made since we first entered. From the onset of our campaign we embarked on a strategy that we considered most suitable for the town's open spaces, in particular focussing on a high community involvement and sustainable planting to take account of climate change and the need to protect our environment. We believe that we have fulfilled our aim so far and continue to do so.

In Kingsbridge our baskets and displays are planted by our own team which is made up of very enthusiastic and talented people who are very focussed on keeping the town thriving and attractive throughout the year. In order to keep our costs down we also carry out all of our own watering and ongoing maintenance.

Our 2015 portfolio is aimed at demonstrating how we have been able to transform the town in many areas and to inspire both our residents and many visitors that, with good horticultural practice and the incentive of Britain in Bloom competition we can help lift the spirit for everyone.

We work to a robust plan that enables us to financially control our planting commitment for existing and future projects.

This year our plan for 2015 is not only to consolidate and further improve our existing displays but to introduce two new major projects.

The first is sited on the embankment and is a floral representation of one of the many world-renowned fruit schooners that were built by shipyards on the Kingsbridge estuary in the 18th century.

The second significant display is featured on our Town Square island bed and depicts a road safety theme sponsored by Devon & Somerset Fire & Rescue, organised and planted by Kingsbridge in Bloom



Raised sustainable bed & borders in the Recreation Ground, Embankment Road



Some of the Kingsbridge in Bloom Team in front of the Town Square Raised Bed

When Kingsbridge in Bloom set out in 2007, we made a conscious decision to plant sustainably and our design for displays around the town have proved this to be an excellent strategy. Additionally, most of our verges in the town have been planted with meadow & wild flower seeds as appropriate, which give a spectacular display of colour to lift the spirit.

We do recognise, however, that for maximum impact, it is necessary to plant annuals in hard landscaped areas so appropriate planting is also carefully considered for each area.

All of our planting is carried out by ourselves including our baskets.



The team after planting one of the many Wild Flower Meadows



We achieve sponsorship from all sized businesses, including Tesco

For some 8 years, businesses, churches, schools and public houses have been, and continue to be, very supportive of the efforts of Kingsbridge in Bloom. Individual organisations brighten their own part of the town by taking steps to improve their immediate open spaces & public realm.



A display from The Jubilee in 2012 by a local hairdressers, Belinda David.



Pupils from Kingsbridge Primary School in their Wild Flower Meadow.



Kingsbridge Beavers being taught by a team member about Wild Flowers & Bees.

Within Kingsbridge there are many gardens, both big and small, ranging from immaculately tendered to the more natural and wildlife friendly; all truly fascinating in their own way.

Kingsbridge in Bloom continues to hold an annual garden competition, where members of the Kingsbridge in Bloom team judge hidden treasures throughout the town in the same way as the town, overall, is judged as part of Britain in Bloom.



Good practices of rainwater use, sustainable planting, extensive composting, wormeries and bee friendly planting are all evident in the Kingsbridge Community Garden. This asset is well used and supported by the wider community of all ages.

Also in the town, hidden away from the hustle and bustle of Fore Street and using the base of the old Primrose Line on the Western fringes of the current town boundary is an area where you will find old bathtubs, carrots, bees, corrugated iron, 12 foot tall sunflowers, innovative irrigation and homemade scarecrows - The Kingsbridge Town Allotments, managed by Kingsbridge Town Council. The allotments have an ever growing waiting list and are well used and maintained by all plot-holders.



Community Garden



Kingsbridge Allotments

Raised beds within the Recreation Ground on Embankment Road, one a formal sustainable (left) and the other a sensory bed (right). The building of both beds, as part of a larger redevelopment of the park, was part funded by monies won through Natwest's Community Force grant.



Town Square formal bed



Town Square sustainable bed

In Kingsbridge we have a number of heritage sites which we have regenerated as well as wildlife areas and natural habitat. Rather than overhauling the natural sites within the town, Kingsbridge in Bloom have worked to enhance the existing features with new additions such as planting of wild flowers in Britton's Field and highlighting the role of the railway branch line that used to run to the town by regenerating the old railway bridge on Plymouth Road.

This year, after much planning, Kingsbridge in Bloom, Kingsbridge Town Council & South Hams District Council have worked closely to provide a new green waste recycling facility at the rear of the Kingsbridge Recreation Ground. We strive to recycle all of our plants and bulbs, with our increased planting throughout the town, this new facility is a major step forward for us.

The planting of our displays are designed in such a way that minimises the requirements for water and compost. All our plants are appropriately recycled or composted as and when required.

Across the South Hams a total of 53% of all household waste is recycled or composted, South Hams District Council is one of just 3 districts in the South West in Bloom area to recycle or compost greater than 50% of it's waste. Kingsbridge in Bloom have played a part in making sure that the composted waste is stored for use in a safe place within the Recreation Ground.

Since Kingsbridge in Bloom started, we have made every effort to influence the reduction of fly-posting, graffiti, litter and we also played a role in developing the new Dog Control orders to reduce the level of dog fouling within the town.

In conjunction with Kingsbridge Town Council, we have been responsible for systematically introducing new Cavendish style seating and replacing old benches with the new style. We have also worked alongside the Town Council with an Art in the Park project which has been installed by students at Kingsbridge Community College. Other art within the town also includes the Community Mosaic which has been installed on the side of Peacocks shop front in Fore Street, an extension of the original Community Mosaic is taking place in 2015 and features new Dog Control signage based on an ancient Roman mosaic design found in Pompeii.



Bees on Sea Holly



Wild Flowers in The Recreation Ground



Dedicated compost area for both SHDC & KIB being created, early 2015.



Recycling hanging baskets within the Recreation Ground

One of the largest sustainable projects Kingsbridge in Bloom has embarked on is the raised bed next to the taxi rank. The project was to turn a very run-down area, next to the main road and at a prominent junction which is used by residents and visitors many times a day, into a thriving example of sustainable & responsible planting.

The raised bed, which was completed in 2009 using funding from the SDLAG, features a 300 gallon tank embedded below the surface for rainwater catchment and is planted, for the majority, sustainably. There is a section for formal planting on the roundabout side. The raised bed was refurbished in early 2015. The formal planting this year is sponsored by Devon & Somerset Fire & Rescue Service and is used to show a safety message.



The above photos show the before (left), during initial refurbishment (middle), and the early planting stages of this years formal display (right).of the raised bed on the Town Square.

In Kingsbridge in Bloom, we take all these strands equally seriously, but while it is easy to see our commitment to both Horticultural Achievement and Community, our environmental policy and practice may not be so clear, so it is set out in a document produced by Kingsbridge in Bloom. Below is an extract:

WE CARE FOR THE ENVIRONMENT BY REDUCING, RE-USING AND RE-CYCLING

Plant management

To Reduce our purchase of new plants

- We ***propagate*** - taking cuttings and growing them on.
- We ***collect seed*** from year to year, germinate and grow on our own plants.
- We ***protect vulnerable plants*** over the winter in poly-tunnels
- Where possible we ***over-winter*** plants in situ to avoid unnecessary expense and labour

We Re-use plants by

- ***Recycling*** bulbs and plants for re-use in different locations – a database indicates what is stored, where

Waste management

We Recycle by

- ***Composting*** appropriate waste material in the compost area in the recreation ground, and take other waste to the local Recycling Centre
- ***Returning*** plant-pots and trays to the suppliers or the recycling centre.
- ***Using reconditioned compost*** either donated or bought locally; if we buy, we buy peat-free.

Water use

We Reduce our demand for treated water by

- ***Using water storage*** such as butts, wherever possible - In the Town Square, there is an underground water collection tank - with a solar pump ready for installation.
- We plant ***perennial, drought-tolerant*** species, where possible
- We use baskets and ***containers with reservoirs***.

The Green Gardening document continues to highlight how Kingsbridge in Bloom designs its planting to attract Bees. Kingsbridge in Bloom purchased a colony of bees in 2012 and donated them to the Community Garden. Their hives, purchased alongside all necessary equipment by the Community Garden, are based in the Community Garden on Fore Street.

The community give great support to Kingsbridge in Bloom, in particular the working parties and involvement from the primary school.

Development of our existing and new heritage sites is ongoing and each managed by a small group of Kingsbridge in Bloom volunteers whose pride in their work regenerate the sites to such a high standard.

Strong engagement and communication with the local schools means that the involvement remains at a high level and their own projects complement their curriculum.

We have a good connections with the local newspapers and free magazine that are distributed door-to-door throughout the area.

The dedicated Kingsbridge in Bloom team work year-round to ensure that all areas worked on are kept in good order with appropriate planting throughout the year.

Support from Kingsbridge Town Council and the business community is crucial in raising a significant percentage of funding required by Kingsbridge in Bloom, other fundraising initiatives include the 100 club, recently re-branded to our "Monthly Prize Draw", and specific events such as quiz nights.

The enormous efforts of the Kingsbridge in Bloom team have played a major part in keeping the town attractive and vibrant. Their dedication is very well appreciated by both residents and visitors of all ages. We particularly appreciate the support of the younger members of our community who are keen to keep involved.



Above, left, shows entries into the Children's Wheelbarrow Garden competition which is held during Kingsbridge Fair Week. Above, right, shows a beaver from Kingsbridge Beavers helping to plant one of our many Wild Flower beds, this one at Britton's Field.



Above, left, Brownies help plant within the Church Street garden in May 2015. Above, right, shows Kingsbridge Cubs doing their bit to keep Kingsbridge Tidy by participating in a community litter pick.

Within Kingsbridge there are 10 It's Your Neighbourhood areas this year, the continued participation by members of the local community keeps areas not currently tended to by the Kingsbridge in Bloom team looking great. As part of the wider community participation, the team run an annual competition where the hidden garden treasures of the town are judged by the Kingsbridge in Bloom team.

The annual local competition, run by Kingsbridge in Bloom, have the following 11 categories:

- Best Large Garden, front and/or back
- Best Small Garden, front and/or back
- Best Courtyard Garden (all plants in Containers and/or Hanging Baskets), front and/or back
- Best Commercial premises
- Best Commercial premises (all plants in Containers and/or Hanging Baskets)
- Best Pub
- Best Church
- Best Street (or part of Street)
- Best Entry Overall for Containers and/or Hanging Baskets
- Best Newcomer, first time entry - any category
- Best Child's Garden or Container, for 16 years and under).

Judging of the local competition takes place towards the end of June 2015 and is always very well entered.



The above photos show two examples of well cared for gardens within Kingsbridge, both have been entries in the annual local competition.



The above photos show examples of businesses helping to brighten up the streetscape of Kingsbridge, Pete's is a clothing store on Fore Street next to the old Town Hall (left) and The Dodbrooke Inn is a public house on Church Street (right).

Below is just a snapshot of the Local Press coverage that Kingsbridge in Bloom receives throughout the year, including, but not limited to, the Kingsbridge & Salcombe Gazette and The Post, a free advertorial magazine delivered to homes across the Kingsbridge area including all surrounding villages. Kingsbridge in Bloom are also regularly mentioned in Letters to the Editor in the local newspaper where we are praised for the work we do.

KINGSBRIDGE STRIKES GOLD!

In this, the 50th year of the RHS Britain in Bloom competition, Kingsbridge has achieved gold status at the very top level in the competition which recognises the very best and most attractive 'Bloom Towns' in the country. Our Kingsbridge in Bloom team were well represented at the awards function that was attended by over 600 delegates at the Civic Centre in Trowbridge. As a past winner of Gold we were invited to take part in the Champion of Champions competition which picks out the very best of the best towns and Cities from previous year's results.

The judging criteria is very strict and scored on Environmental Responsibility, Horticultural Excellence and Community Participation. Usually each town and city is grouped on size of population for it's entry but at this highest level, it is based on actual achievement against the criteria so it was with great surprise that we also won and share best in group trophy with the City of Truro.

Quote: The KIB team have worked so hard again this year and after much planning, our displays have improved again.

We are so fortunate to have a great talented group of volunteers who all enjoy dedicating their time to this worthy cause for the benefit of the whole community... and we enjoy it.

I must also thank the great work that is done by 'It's Your Neighbourhood' groups in the town who have done an excellent job in looking after their patch. This year we had six groups who entered this category and all achieved the very top awards and they were very well deserved. Next year we hope that more groups will come forward to enter and also volunteer help us continue to promote pride in our town and keep it looking attractive.

Thanks also go to KTC, SHDC and the businesses who give us their full support.

Graham Price
Chairman KIB
Website: www.kingsbridgeinbloom.co.uk

Flying the flag for community spirit

By SAM ACCOURT

KINGSBRIDGE is flying the flag for community spirit, as the town has been crowned the most attractive in the South West region in the annual RHS Britain in Bloom competition.

The town's success was celebrated at a ceremony at the Civic Centre in Trowbridge, where the Kingsbridge in Bloom team were presented with the Gold award trophy.

The team, led by Chairman Graham Price, included members of the town's various horticultural and community groups, who have worked tirelessly to improve the town's appearance throughout the year.

The award is a recognition of the town's commitment to horticulture and community spirit, and is a testament to the hard work and dedication of the Kingsbridge in Bloom team.

The town's success was a result of the efforts of many individuals and groups, who have worked together to create a more attractive and welcoming environment for all.

The Kingsbridge in Bloom team will continue to work hard to maintain the town's status as the most attractive in the South West region, and to ensure that the town remains a place where everyone can be proud to live.

Kingsbridge In Bloom

If you have been on the Town Square on recent Wednesday mornings you probably spotted the Kingsbridge in Bloom team proudly sporting their blue shirts. The Town Square beds have been the object of intensive work over the past few weeks to give them a real facelift.

The work was carried out by the Kingsbridge in Bloom team, who have been working hard to improve the appearance of the town's public spaces. The team has been responsible for a range of projects, including the creation of new flower beds, the maintenance of existing ones, and the planting of new plants and trees.

The work has been carried out in a number of locations, including the Town Square, the Market Place, and the various parks and gardens in the town. The team has been working hard to ensure that the town's public spaces are as attractive as possible, and to provide a welcoming environment for all.

The Kingsbridge in Bloom team is a group of volunteers who are passionate about horticulture and community spirit. They work together to improve the appearance of the town, and to provide a range of activities and events for the community.

The team's work is a testament to the commitment of the Kingsbridge in Bloom team, and to the hard work and dedication of all the volunteers who make up the team.

Let's all get blooming busy

YOUNG PABE, of Farnborough, has been busy in the town of Kingsbridge, working on the town's public spaces. The young man has been working on the town's public spaces, including the Town Square, the Market Place, and the various parks and gardens in the town.

The work has been carried out by the Kingsbridge in Bloom team, who have been working hard to improve the appearance of the town's public spaces. The team has been responsible for a range of projects, including the creation of new flower beds, the maintenance of existing ones, and the planting of new plants and trees.

The work has been carried out in a number of locations, including the Town Square, the Market Place, and the various parks and gardens in the town. The team has been working hard to ensure that the town's public spaces are as attractive as possible, and to provide a welcoming environment for all.

The Kingsbridge in Bloom team is a group of volunteers who are passionate about horticulture and community spirit. They work together to improve the appearance of the town, and to provide a range of activities and events for the community.

The team's work is a testament to the commitment of the Kingsbridge in Bloom team, and to the hard work and dedication of all the volunteers who make up the team.

It's gold again for the green fingered brigade

Members of Kingsbridge in Bloom pose with their prizes at the awards ceremony in Trowbridge, Wiltshire.

by TOBY LEIGH

THE town of Kingsbridge has again done the honours in the annual RHS Britain in Bloom competition, winning the Gold award for the second year running.

The town's success was celebrated at a ceremony at the Civic Centre in Trowbridge, where the Kingsbridge in Bloom team were presented with the Gold award trophy.

The team, led by Chairman Graham Price, included members of the town's various horticultural and community groups, who have worked tirelessly to improve the town's appearance throughout the year.

The award is a recognition of the town's commitment to horticulture and community spirit, and is a testament to the hard work and dedication of the Kingsbridge in Bloom team.

The town's success was a result of the efforts of many individuals and groups, who have worked together to create a more attractive and welcoming environment for all.

The Kingsbridge in Bloom team will continue to work hard to maintain the town's status as the most attractive in the South West region, and to ensure that the town remains a place where everyone can be proud to live.

And now we wait

One of the displays on the Quay - results will be announced on September 18

KINGSBRIDGE in Bloom's hard work over the year culminated in the judging which took place at the weekend.

The main town judging for the entry into the Champion of Champions Britain in Bloom took place on Friday, with the Royal Horticultural Society Judge John Goudson having a two-hour tour of the town.

He took in Kingsbridge Primary School, who got to show off their 'own grows' produce and paintings, before the journey continued to the Methodist Church with floral displays commemorating its 200th anniversary.

The tour finished at St Edmund's Church where he was able to see the Kingsbridge in Bloom display and meet the team and supporters.

The 'It's Your Neighbourhood' entry was judged on Saturday. These were the areas within the town that local residents take responsibility for and maintain.

President Graham Price commented on the 'very high standard' of these areas and how they are 'very much part of the Kingsbridge in Bloom story'.

Judging of Britain in Bloom is ongoing nationwide until the end of July and the South West results will be announced at an awards ceremony at the Civic Hall in Trowbridge on September 18.

The Primrose Line ran as a branch line from South Brent, on the edge of Dartmoor, to Kingsbridge from 1893 until September 1963 when it's final train ran. The bridge to the north of Plymouth Road is the most prominent remaining reminder of the town's previous infrastructure and is one of 4 within the town, others can be found at Lime Grove, Hurrell Road, and at the end of Stentiford Hill. The bridge is part of an It's Your Neighbourhood entry.



The Town Square's existence is only due to infill at the top of the Kingsbridge Estuary. Formerly a Car Park, the current use is the main space for regular markets, charity events, an annual Food & Music Festival and is extensively used during Kingsbridge Fair Week. Neglected with poor maintenance for a number of years, the Kingsbridge in Bloom team took over the design & maintenance in 2008 and redesigned wholly in 2015.



The Recreation Ground, between Embankment Road and Derby Road, was previously a tidal creek of the Kingsbridge Estuary and was made dry during the construction of Embankment Road. The resulting salt-water boggy meadow, known as "The Marsh", was drained in time and has been a park since 1918, when the Kingsbridge Community felt it should be used to honour the courage and sacrifices of so many in World War One. Public donations resulted in the opening of the "Kingsbridge War Memorial Public Recreation Grounds". Many layouts of the park have existed, the current incarnation began in 2008 and the refurbishment was completed in early 2013 with minor improvements and changes since.



During the past few years South Hams District Council's Ground Maintenance Team have helped develop their own displays throughout Kingsbridge, with continuing consultation with Kingsbridge in Bloom, the improvements have transformed previously less impressive displays into co-ordinated floral displays.



Kingsbridge in Bloom could not exist without the kind support from our sponsors.

Barton's Solicitors

Creeks End

Devon & Somerset Fire and Rescue

Fine Shine

Greencrop

Harrison Nurseries

Herring Shoes

Kingsbridge & Salcombe Chamber of Commerce

Kingsbridge Community Garden

Kingsbridge Estuary Boat Club

Kingsbridge Gardening Club

Kingsbridge Gazette

Kingsbridge Town Council

Kingsbridge WI

Nick Walker Printing

Otter Nurseries

Palladium Builders Merchants

Patch and Acre

Pizza Planet

Quay Quilters

R&G Auto Spares

Rotary Club of Kingsbridge Estuary

South Hams District Council

Tesco

The Post

Toad Hall Cottages

Torr View Forge

TriOcean

Wills Marine



The Schooner display, featured on the front page of this Portfolio, on Embankment Road is a new feature for 2015, crafted by Torr View Forge at Torr Quarry on the outskirts of Kingsbridge. Installation & planting of the Schooner took place in late May 2015. Early responses from visitors and residents have been fantastic, it's a rarity to see the new Schooner not being photographed.

Many boatyards were located around the Kingsbridge estuary, and some fine fruit schooners were built here. Ringleader was built at the Evans yard in 1864 as a schooner and was the largest built at the time.

In 1871 she was registered as a Brigantine, a two masted sailing ship with square rigging on the foremast and fore-and aft rigging on the main mast. Her owner was Balkwill and Co. and her Captain, Edward Quick.



The sponsors for this display are Bartons Solicitors, Triocean, Rotary Club of Kingsbridge Estuary

Kingsbridge in Bloom (KIB) consists of a committee, with links to a wide range of other individuals and organisations with whom we work closely.

This year the committee has been made up as follows:

| | |
|----------------------------------|--|
| Graham Price | Chairman, project manager, interface with local Councils, RHS & SWIB, business participation & sponsorship |
| Anne Balkwill | Liaison with local councils, fund raising, working parties |
| Grenville Taylor | Committee Treasurer, Monthly Draw organiser, liaison with Cookworthy Museum |
| Chris Barnwell | Committee Minutes Secretary, links with Walkers are Welcome & Ramblers, working parties |
| David Dain | Committee member, working parties and support to locality schemes, liaison with Kingsbridge Community Garden |
| Jackie Case | Committee member, gardening & plants expert, working parties, liaison with Kingsbridge WI |
| Gill Matthews | Committee member, publicity officer, working parties, local Kingsbridge in Bloom Garden competition organiser |
| Rob Harkness | Committee member, SHDC Open Spaces Manager, liaison with KIB |
| John Speed | Committee member, equipment maintenance & watering, working parties, links with Kingsbridge Community Garden and Agenda 21 |
| Jan Finbow | Committee member, community liaison, working parties, liaison with Gardeners Club, local Kingsbridge in Bloom Garden competition organiser |
| Brian & Jennie Hayden | IYN co-ordination, advice & working parties |
| Robin Griffin | Working parties and School liaison |

The committee would also like to acknowledge the support to Kingsbridge in Bloom from the KIB team of volunteers, and the many others who have supported us through the year. These include the Kingsbridge Scouts and Girl Guides, Kingsbridge Primary School and Community College, the Churches in the town and the many individual members of the community who have contributed their time and expertise so freely to support our campaign. Additionally, Kingsbridge in Bloom would like to thank Cat Saunders from National Trust Overbecks in Salcombe for her invaluable contribution and advice to the team for the Town Square beds refurbishment and also Stuart Hollett from Torr View Forge in helping design, and manufacture our heritage floral schooner display for 2015.

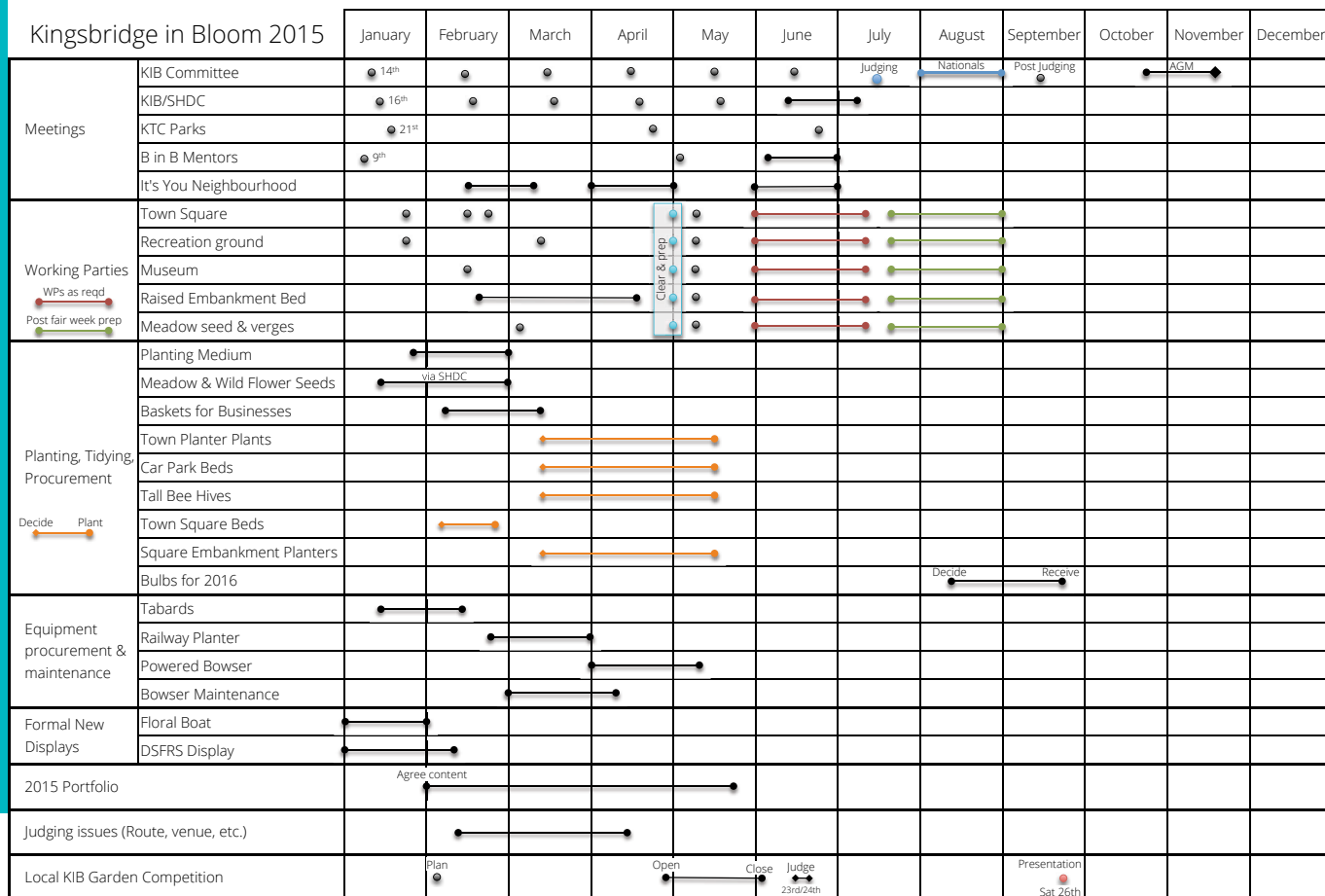

Above is our new style Project Management plan for 2015, this is used to provide a snapshot of how the work we do should fit in to our working year. A more detailed planting programme is created October - September and is regularly updated, opposite is the June updated programme.

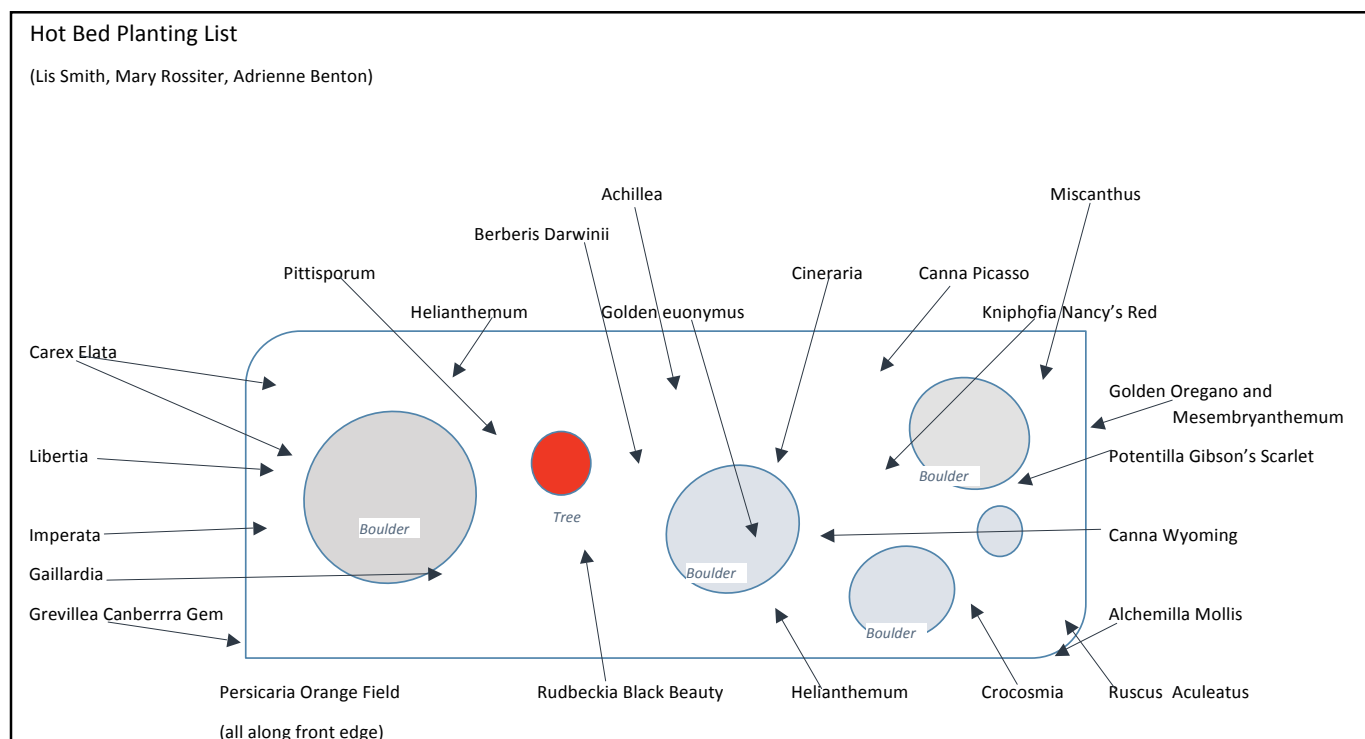

Above is a plan for one of our new Town Square Beds, these are distributed to members of the working party before meeting and is used as a reference point to maintain the initial planned design throughout the year.

KIB Planting Programme 2014/15 – June

| Month | Tasks/Activities | Who? |
|------------------|--|--|
| October | Tulips and bulbs in/Town Square + Winter bedding Compost refresh if needed – re-use bulbs and primis. Audit rec/clean beds/plant bulbs Car Park beds – check and re-stock if needed Audit Town Square planting Hang winter baskets | All to plant All JC/AT/working parties Gardeners Club With Cat Saunders/Overb. AB and Potters |
| November | Empty and re-fill Beehive planters Foliage call – for Xmas wreaths - via Gazette/Post/website Holly wreaths (24) – buy supplies Embankment planters – bulbs etc Verge planting at railway gateway Duncombe Park planters Discuss creating town planting map with sites/owners/sponsors*** | W party – early Nov. Publicity team JC JC DD and team DD At AGM? |
| December | Wreath-making (3 rd and 5 th at Barnwells, Bernagh, Duncombe St) Stall – Kingsbridge Celebrates Christmas – Sat 6 th - GM to coordinate | Volunteers Joint with Museum |
| January | Cutting back/winter tidy – ongoing – esp Town Square/embankment and Rec Order wild-flower seed, in conjunction with SHDC Visit Overbecks, re T Sq planting - <i>develop plan</i> | All GP <i>Planting teams</i> |
| February | Prepare ground for new plants + wild-flowers (all sites) Order extra/replacement plants for Rec/Town Square etc Museum garden Clean stone bed on embankment - cement in loose stone | Working Parties Planting team Small working party Working party |
| March | Order baskets/plants from Potters Business basket orders Wild-flower sowing – prior rotavation by SHDC Replant Town Square following soil renewal – completed April | AB/JC GP/RG - done Working parties/SHDC Working parties |
| April | Change/refresh compost Order/buy bedding for Town Square main planting and features + other containers e.g. Duncombe St and Railway Bridge, gateways, roundabout, top car park | Working party Planting team, Gardeners Club and others |
| May | Main baskets – planting at Potters – Tuesday 5th Car park beds Clear beds for replanting/recycling** (need host gardens) Weed stone beds and prepare for planting Prepare ground and plant bedding – features/Town Sq & rec etc Hang baskets – late May | AB and team JF and Gardeners Club W/parties W/p W/p Potters and team |
| June | Plant bee-hives <i>after Music Festival</i> Watering/weeding Pre-judging review and tweaking | Working party All |
| July | Ongoing watering and weeding Final clearing/tidying pre-judging | All |
| August | Plan/order bulbs for next year Continue watering, dead-heading etc. | Planting team |
| September | Begin Bulb planting Remove summer baskets after K/b Show | All Potters |

Kingsbridge in Bloom 2015

Appendices to Portfolio

- 1. Planting update 2015**
- 2. Recreation Ground plans**
- 3. Town Square plans**
- 4. Financial summary**

APPENDIX 1

PLANTING UPDATE 2015

Recreation Ground

This underwent a major makeover in 2012 with the building of two substantial raised beds by the South Hams team, with easy wheelchair access all round.

A KIB team then drew up a design for sensory planting, with one bed featuring hot colours and the other more muted blues and pinks.

Each bed contains plants to stimulate the senses, including the palate. Herbs and edible plants are grown alongside scented plants such as pinks, and grasses were added for movement and gentle sound.

In July of 2012, the planting suffered a major setback with total inundation, following torrential rain. This led to a compacting of soil, but many of the plants rose to the challenge and carried on flowering. However, others were unable to withstand the drenching, and the wind which is a feature of the site. Each year, therefore, some re-planting has been needed and this year there has been a detailed regeneration, as indicated on the plans, with the inclusion of some plants as wind-breaks.

We have also developed the bed in front of the café with herbs and colour, and for the first time in 2015 have dug out an extra border to the right of the café area, planted with nerines and other donated plants.



Town Square

The Town Square was first planted in 2011, as the second phase of the town centre planting.

The 2011 planting was very much dominated by monochrome grasses and other plants, many of which failed to thrive or inspire and, bearing in mind the very prominent position of the Square and its exposed coastal site, a decision was taken to seek guidance on improving the planting. To this end, we sought the advice of Catrina Saunders, head gardener at NT Overbecks in Salcombe.

In December, Cat came on a Walkabout to see how planting might be improved, and subsequently invited us to visit Overbecks in early Spring, to look at possible plants for inclusion. She then very generously donated plants from Overbecks. Her entire contribution was free of charge.

Three teams then set about designing a new planting scheme to enhance the area, and produced the current design, with colour continuity throughout. All of the participants took immense pride in their planning and were very grateful for the input of the wider team in planting and finishing the project. The accompanying plans show the scheme in detail.

EAST



Red Bed (B)

EAST

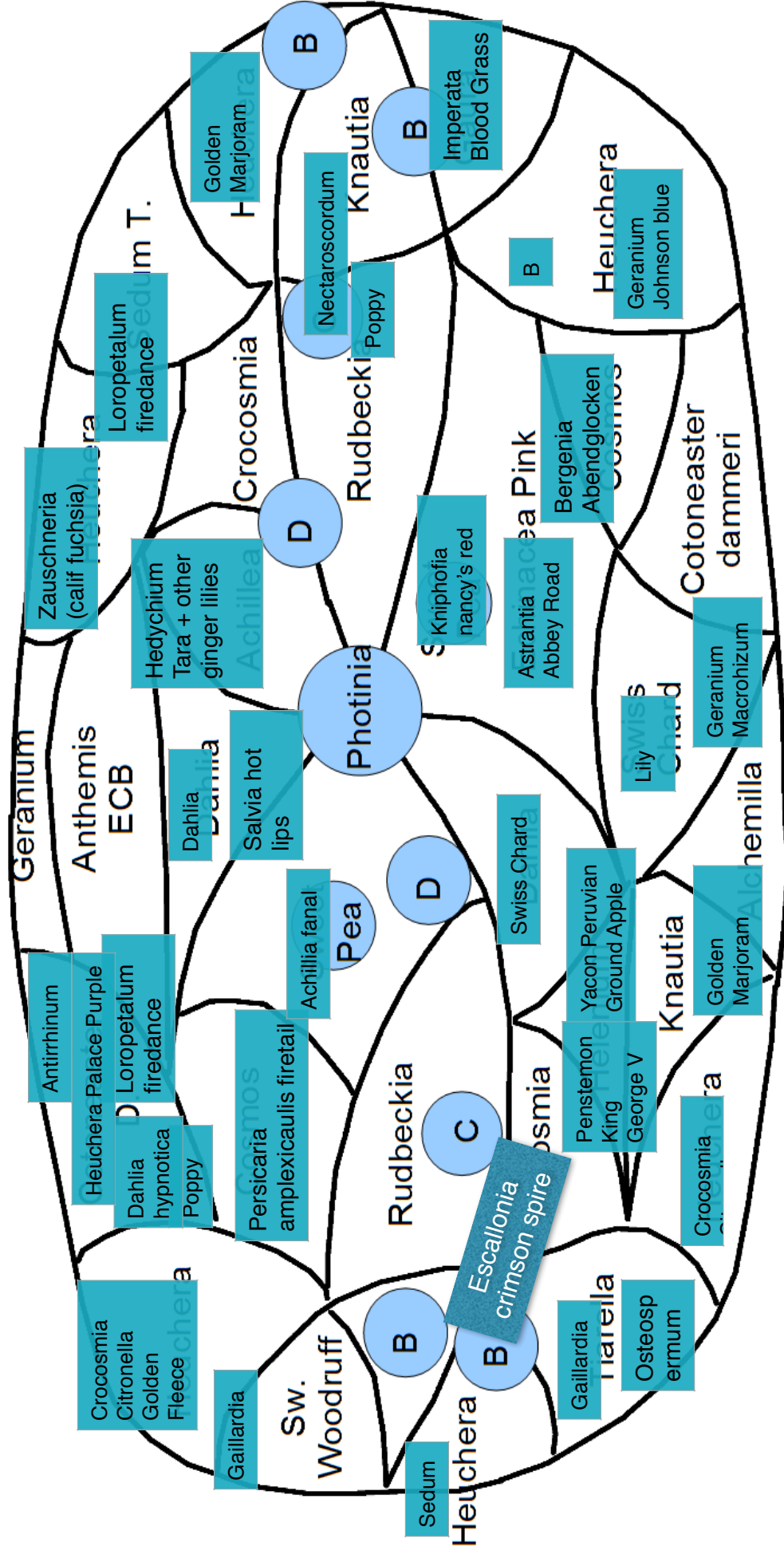

- B Cornus sanguinea mf
- C Alba Sib.
- D Flaviramea

Bractantha sundaze

Appendix 3

Crossing Bed Planting List

(Denise Bates, Jan Alen, Angela Taylor)

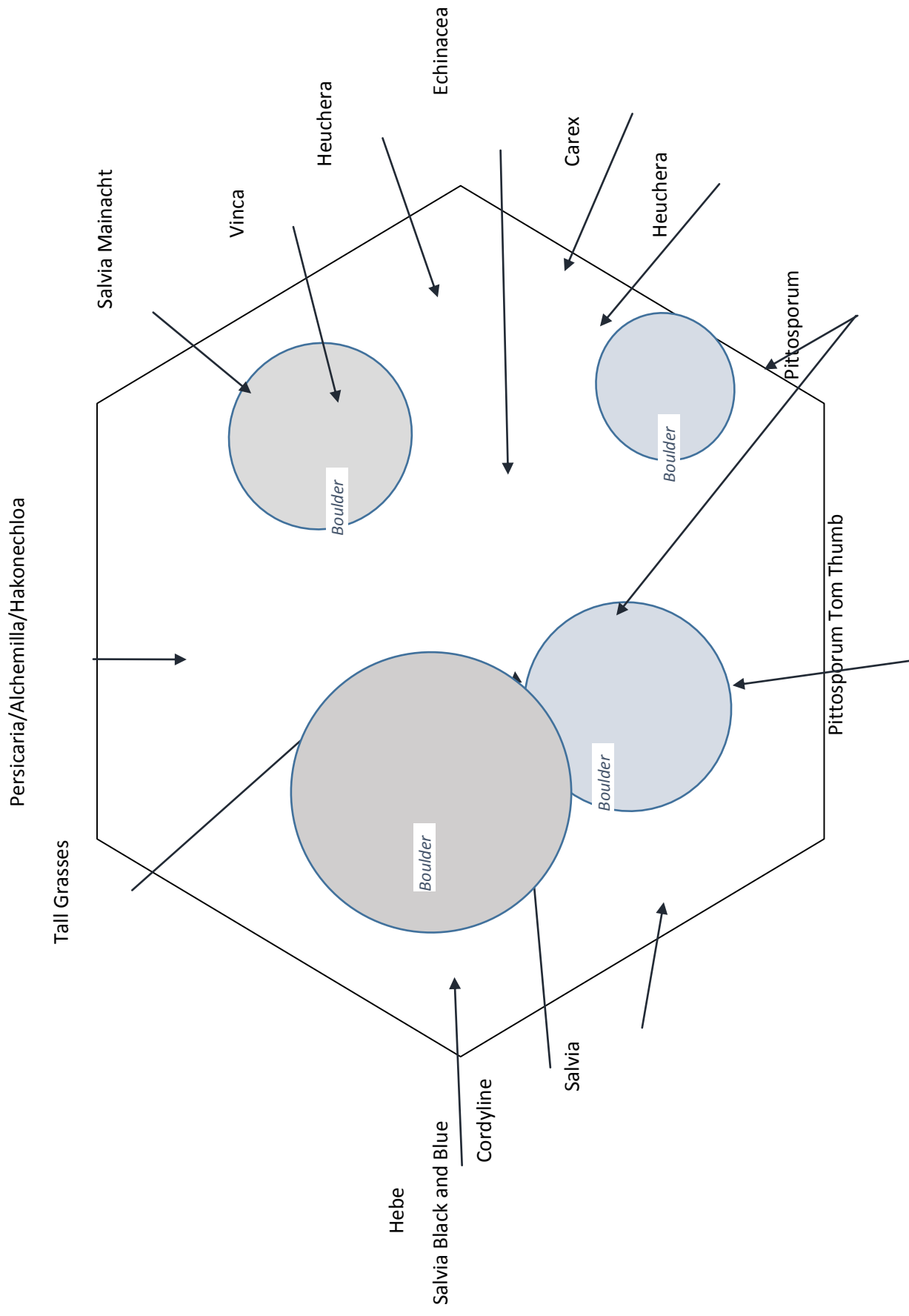

Central Bed Planting List

(Denise Bates, Jan Alen, Angela Taylor)

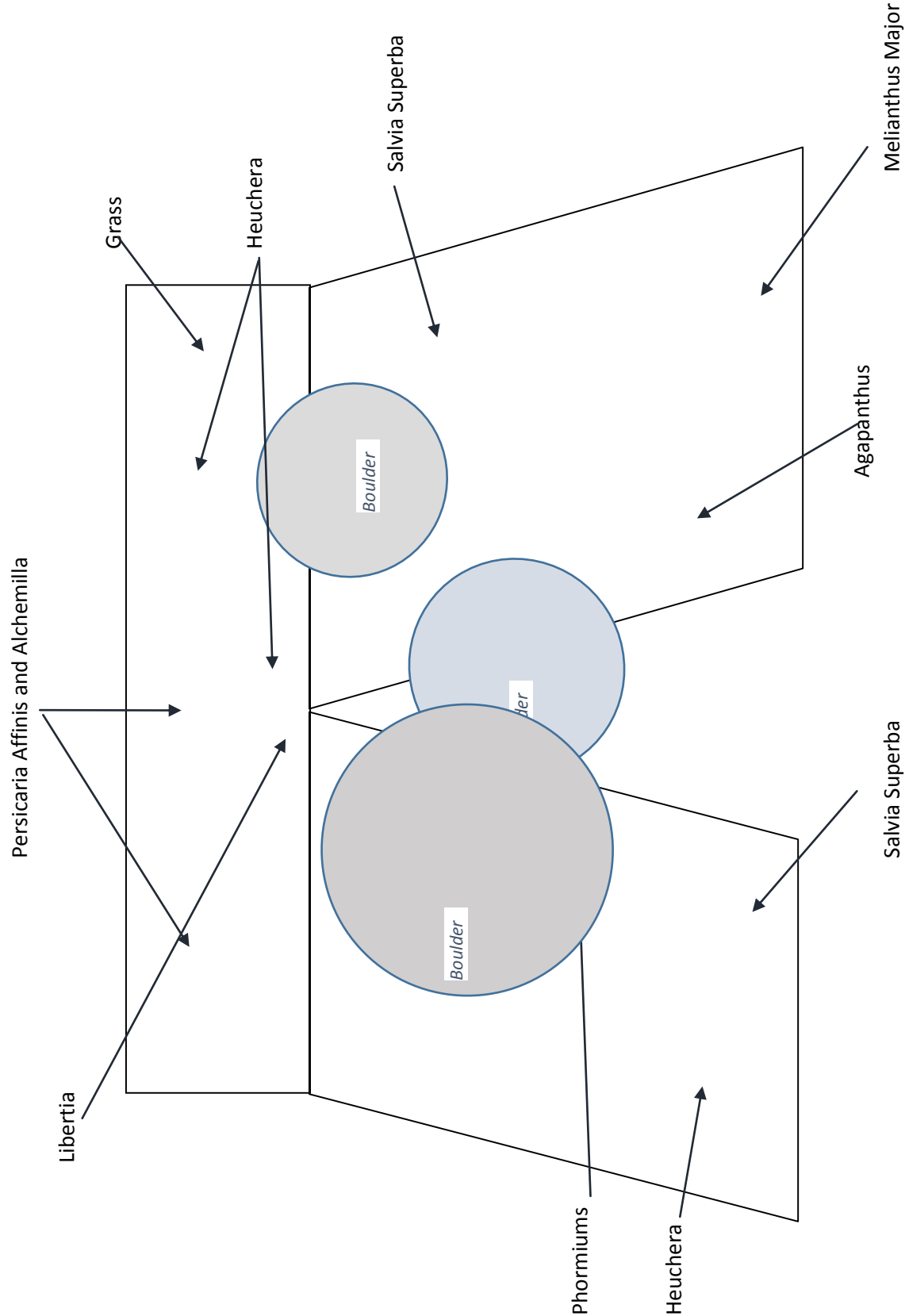

Right Hand Bed Planting List

(Denise Bates, Jan Alen, Angela Taylor)

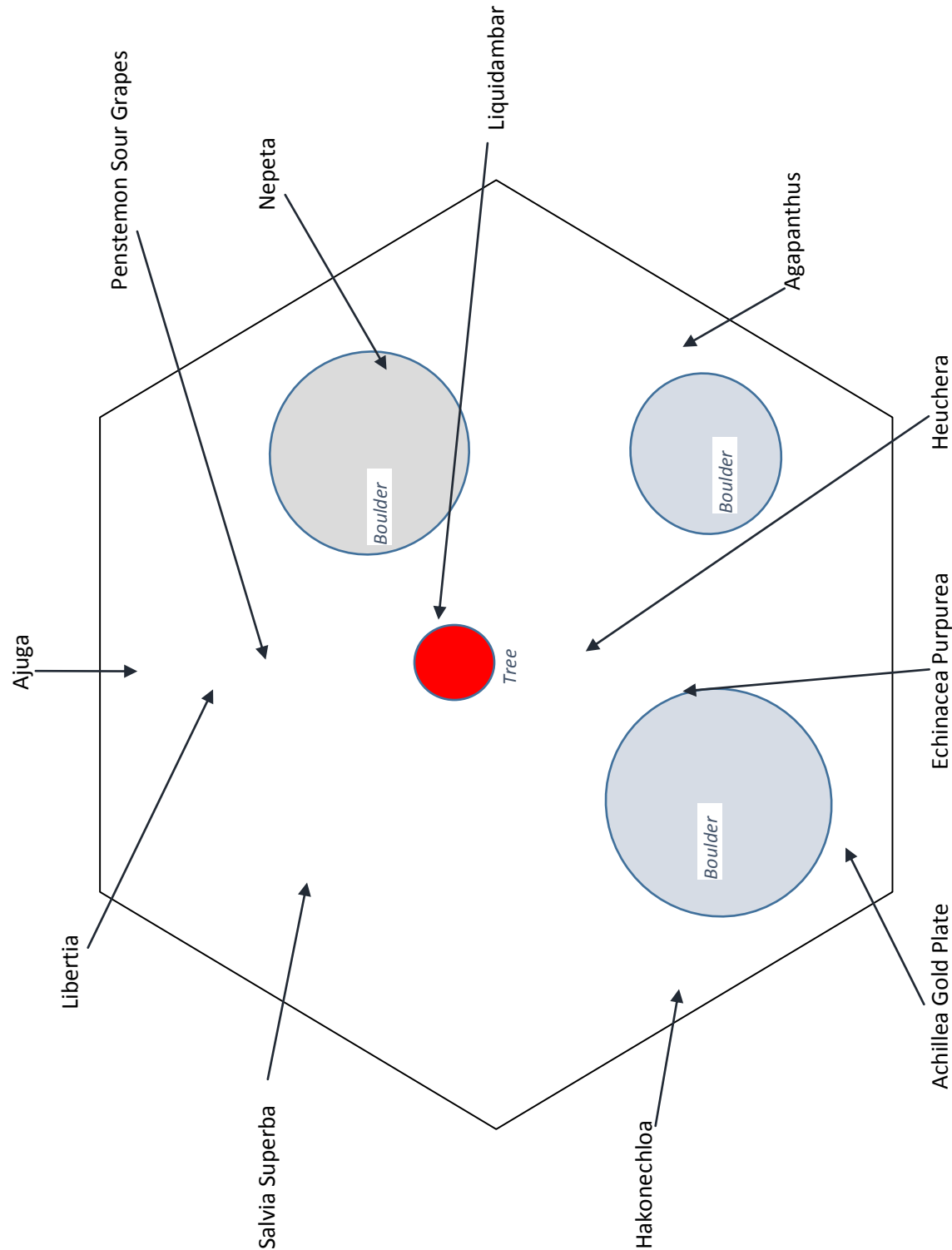

Corner Bed Planting List

(Angela Taylor, Jennie Hayden, Vivienne Mugford, Jan Thomas-Gourd)

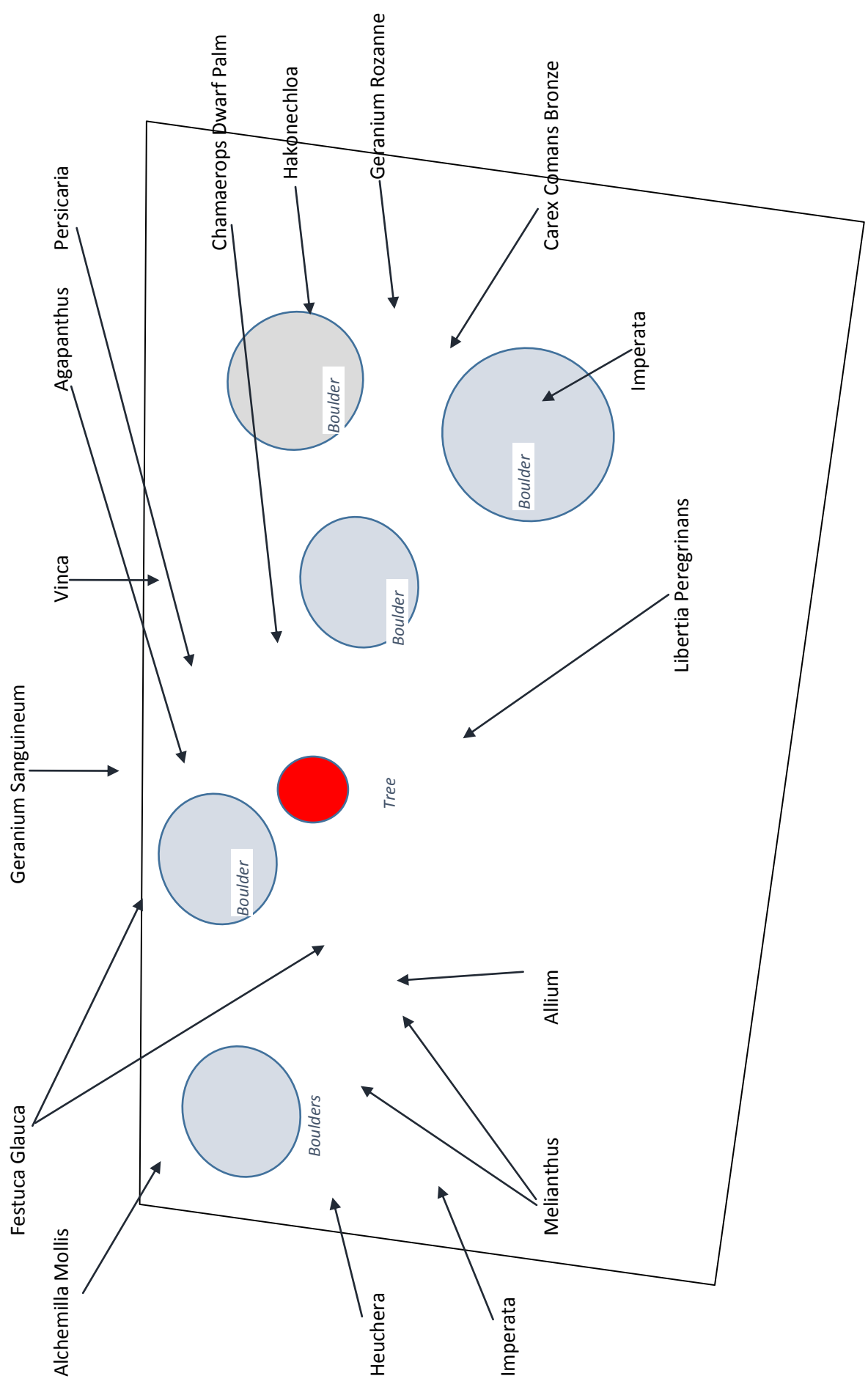

Hot Bed Planting List

(Lis Smith, Mary Rossiter, Adrienne Benton)

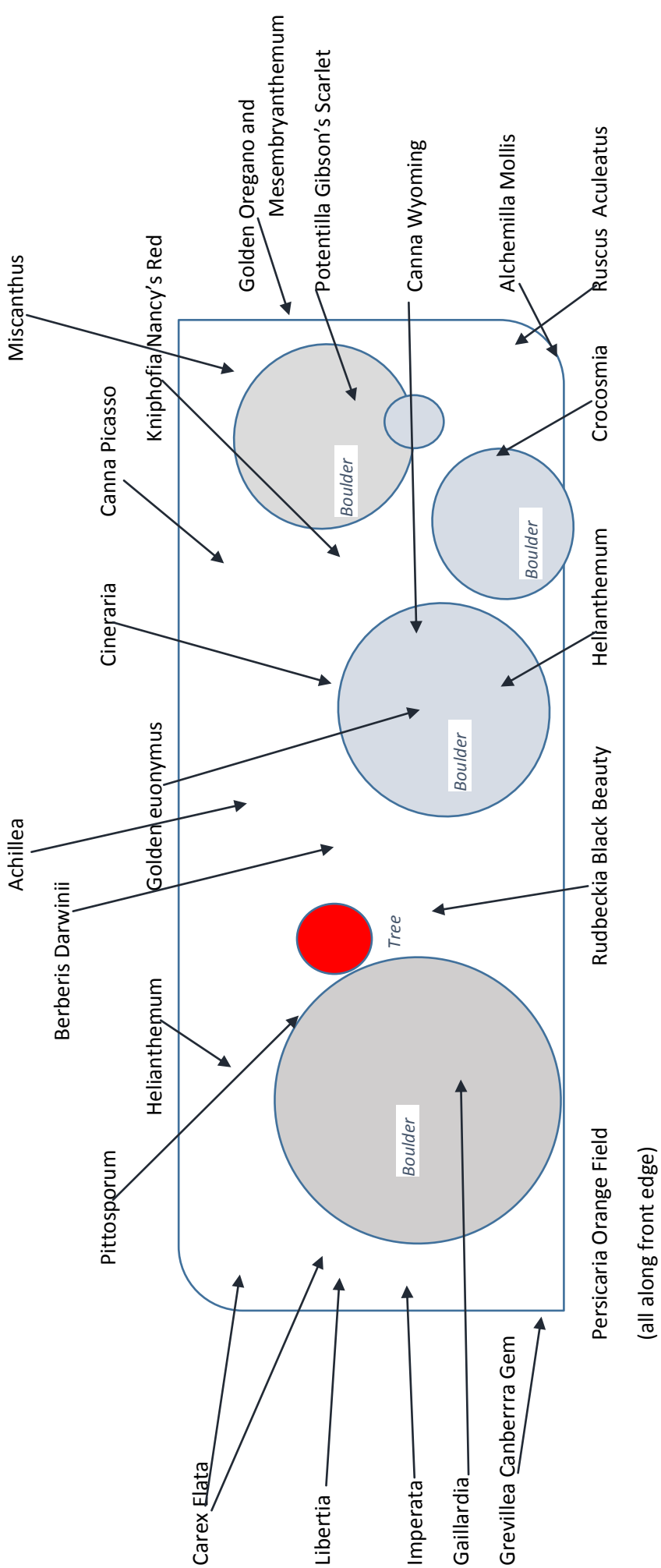

Appendix 4

Kingsbridge in Bloom Financial Summary for 2014/5 Campaign

The figures below include estimates through to the end of the Season.

Income

| | |
|---|----------------|
| 100 Club/Monthly Prize Draw Net Income* | £1,316 |
| General donations | £3,204 |
| Shop Baskets/Displays | £760 |
| Grant Kingsbridge Town Council (KTC) direct** | £2,000 |
| Donations tied to major New Displays | £894 |
| Donations tied to major New Displays direct** | £2,422 |
| Total | £10,596 |

Expenditure

| | |
|---|----------------|
| General displays | £3,963 |
| Shop Baskets/Displays | £760 |
| Expenditure tied to major New Displays – direct** | £3,136 |
| Estimated Miscellaneous Expenditure*** | £700 |
| Equipment KTC direct* (new bowser, lawn mower) | £1,600 |
| Total | £10,159 |

NOTES

- * Income from MPDraw is 50% to 55% of gross income. Includes estimate for rest of season
- ** Some sponsors pay directly for displays, rather than paying KIB to pay suppliers. Also includes value of donation in kind from Torr View Forge.
- *** Administration, publicity, equipment maintenance

Charts shown on next page

Income

For 2014/5 Campaign

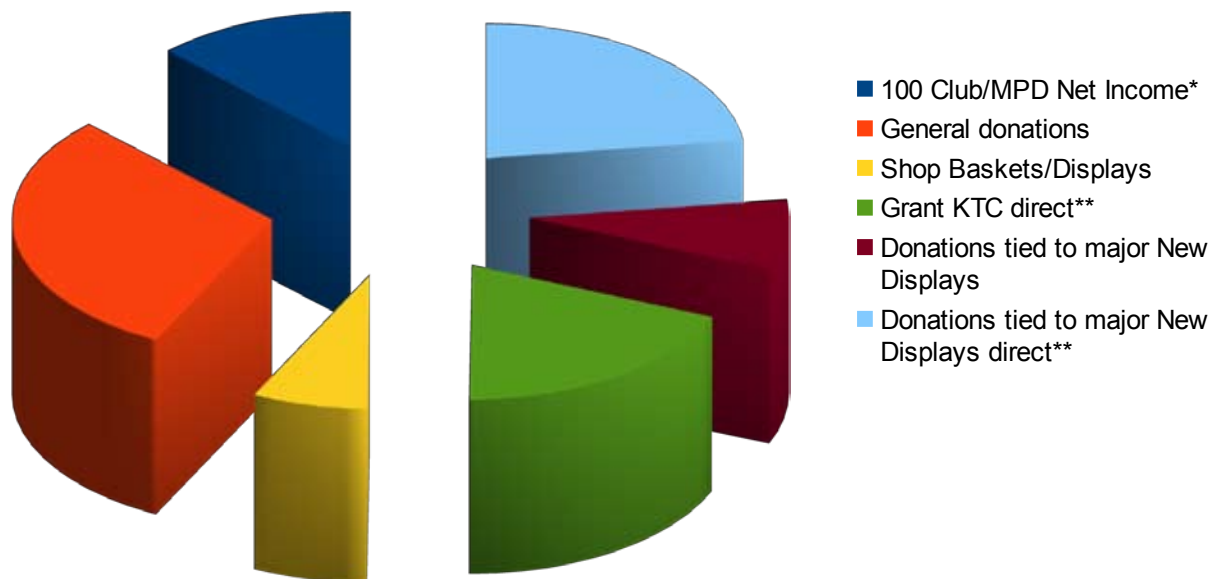

Expenditure

For 2014/5 Campaign

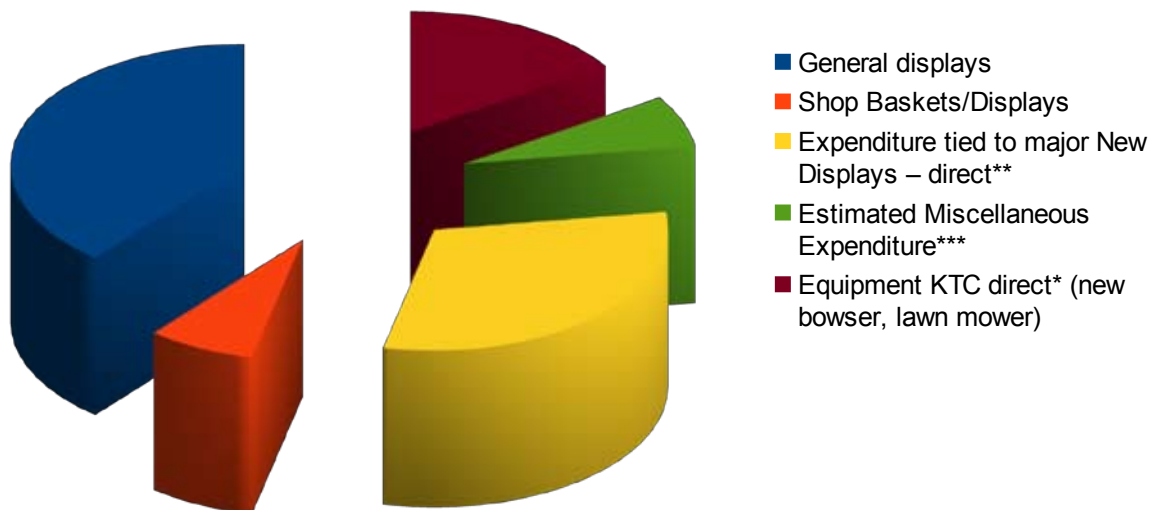

Kingsbridge In Bloom



www.kingsbridgeinbloom.co.uk